

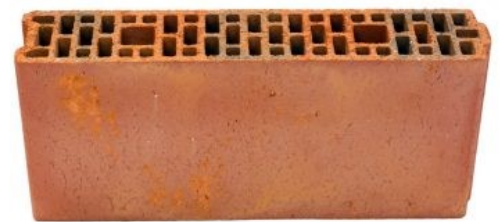

Porotherm Clay Block PLS 100

Product Technical Information Sheet

Wienerberger Code	1368100
Production Plant	Zonnebeke (Belgium)
Manufacture	Extruded
Colour	Terracotta
Work Size (mm)	500 x 100 x 224
Pack Quantity	100 No.
Typical Pack Weight	1142 kg



Technical Properties to BS EN 771-1

Size Tolerance (Mean/Range)	T1/R1
Gross Dry Density (kg/m ³ /Tolerance)	950 (D1)
Compressive Strength (N/mm ²)	≥10
Thermal Conductivity (W/(m·K))	P=90% 0.27
$\lambda_{10,dry,unit}$ value (EN 1745 tabulated: S1)	$\lambda_D = 0.29$
Durability Designation	F0
Water Absorption (%)	≤18
Initial Rate of Water Absorption (kg/(m ² ·min))	Min. 0.5 Max. 2.0
Active Soluble Salts	S0
Reaction to Fire	Class A1

Issue Date: 21/12/2020

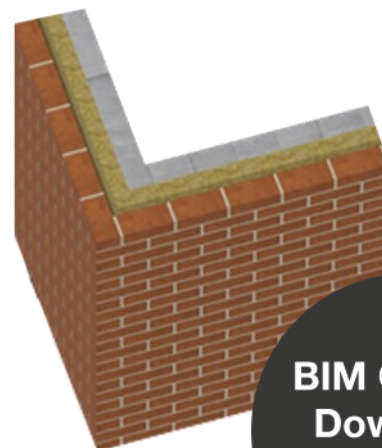

**BIM Objects
Download**

