

# Porotherm Clay Block PLS 140

## Product Technical Information Sheet

Wienerberger Code	1368140
Production Plant	Zonnebeke (Belgium)
Manufacture	Extruded
Colour	Terracotta
Work Size (mm)	500 x 140 x 224
Pack Quantity	72 No.
Typical Pack Weight	947 kg



## Technical Properties to BS EN 771-1

Size Tolerance (Mean/Range)	T1/R1
Gross Dry Density (kg/m <sup>3</sup> /Tolerance)	850 (D1)
Compressive Strength (N/mm <sup>2</sup> )	≥10
Thermal Conductivity (W/(m·K))	P=90% 0.24
$\lambda_{10, \text{dry, unit}}$ value (EN 1745 tabulated: S1)	$\lambda_D = 0.26$
Durability Designation	F0
Water Absorption (%)	≤18
Initial Rate of Water Absorption (kg/(m <sup>2</sup> ·min))	≤2
Active Soluble Salts	S0
Reaction to Fire	Class A1

**Issue Date: 21/12/2020**

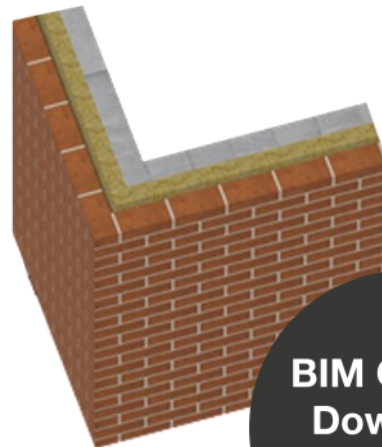

**BIM Objects  
Download**

